

# Préau

THE FOUR-SEASON  
POLYDOME

MULTI-PURPOSE  
VERSATILE  
ENERGY EFFICIENT





DURING WINTER, PREAU IS A

## NHL-SIZE REFRIGERATED ICE SURFACE PROTECTED FROM THE WEATHER!

FROM NOVEMBER 15  
TO MARCH 15  
WITH NO INTERRUPTION

---

PUBLIC SKATING

MUNICIPAL ICE SPORTS PROGRAMS  
(HOCKEY, FIGURE SKATING, SPEED SKATING)

RECREATIONAL LEAGUES

TOURNAMENTS, MATCHES, GAMES, SHOWS  
AND EVENTS

AND THROUGHOUT THE YEAR,

A STRUCTURE THAT CAN  
SUPPORT AND GUARANTEE A  
**VARIETY OF OTHER PROGRAMS**

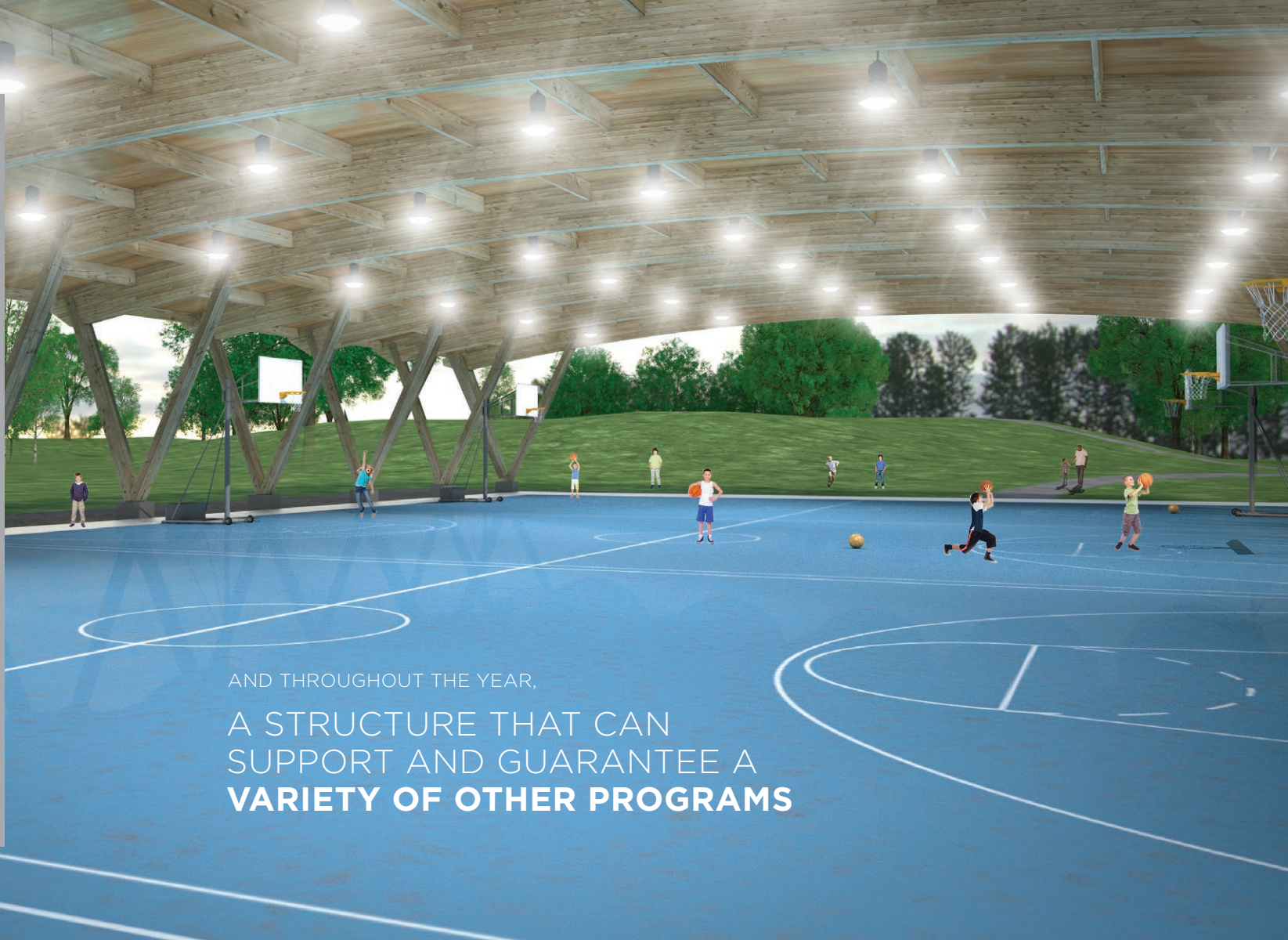



## MANY OTHER PROGRAMS POSSIBLE

### PUBLIC AND ORGANIZED SPORTS ACTIVITIES

SOCCER, BASKETBALL, HOCKEY DECK, TENNIS

### CULTURAL EVENTS

SHOWS, EXHIBITIONS, OUTDOOR CINEMA

### COMMUNITY EVENTS

PUBLIC MARKET, FLEA MARKET, TRADE SHOWS, PARTIES

### DAY CAMP

PLACE FOR GATHERINGS AND ACTIVITIES

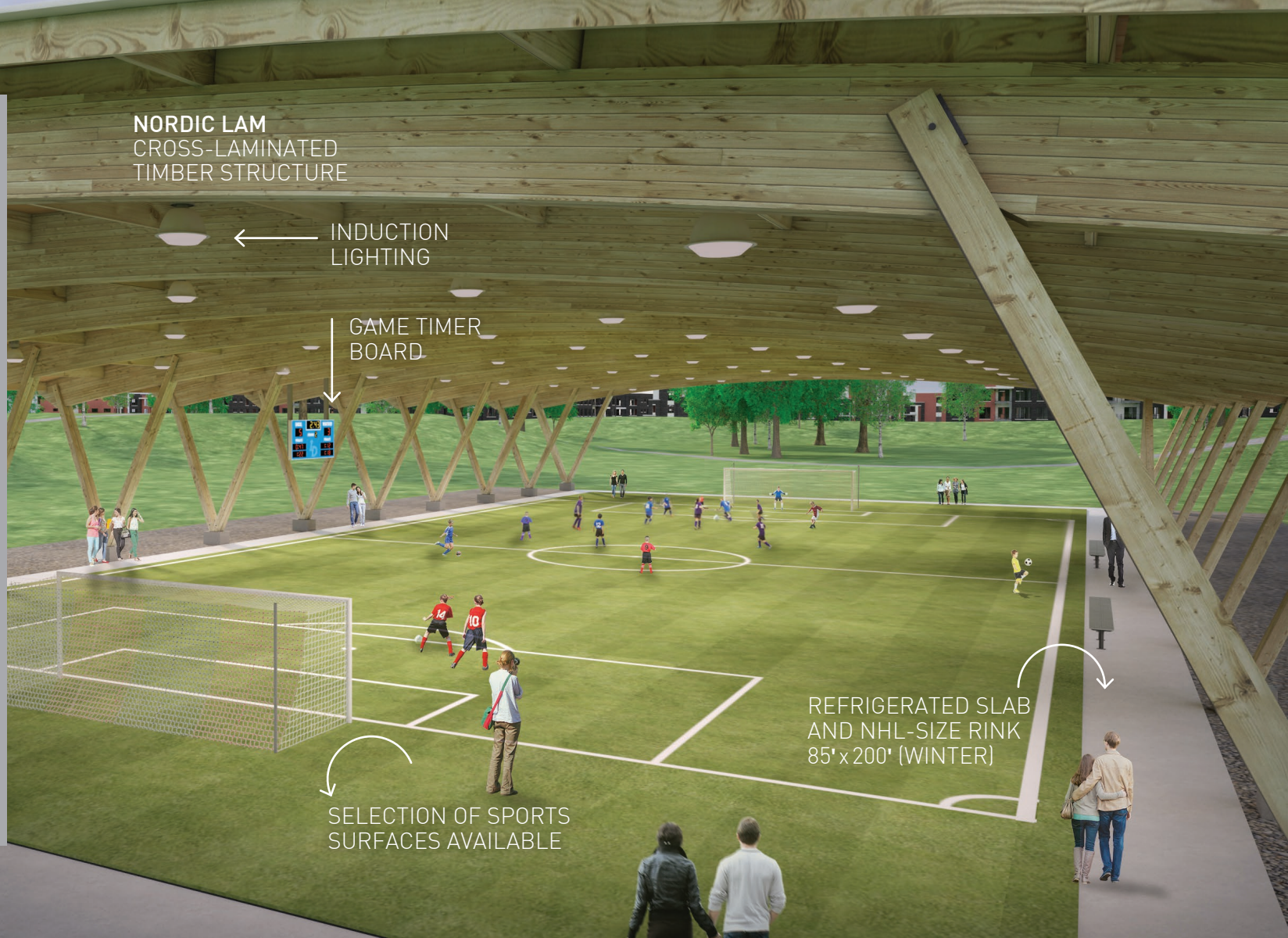

## MAIN COMPONENTS

- + HIGH-QUALITY BOARDS WITH INTEGRATED GLAZED BAYS (GLAZED BAYS: 5' AT THE ENDS AND 4' ON THE SIDES)
- + PROTECTIVE FILLETS AT THE ENDS
- + WATER OUTLET FOR WATERING
- + SIDEWALK AROUND THE REFRIGERATED SLAB AND LANDSCAPING
- + GOAL NETS AND ANCHORS
- + PLAYERS' BENCHES AND RADIANT HEATING SYSTEM
- + AND OTHER OPTIONAL COMPONENTS: SELECTION OF DIFFERENT SPORTS SURFACES IN THE SUMMER SEASON, SPORTS EQUIPMENT, BLEACHERS, PROTECTIVE CURTAINS, ETC.

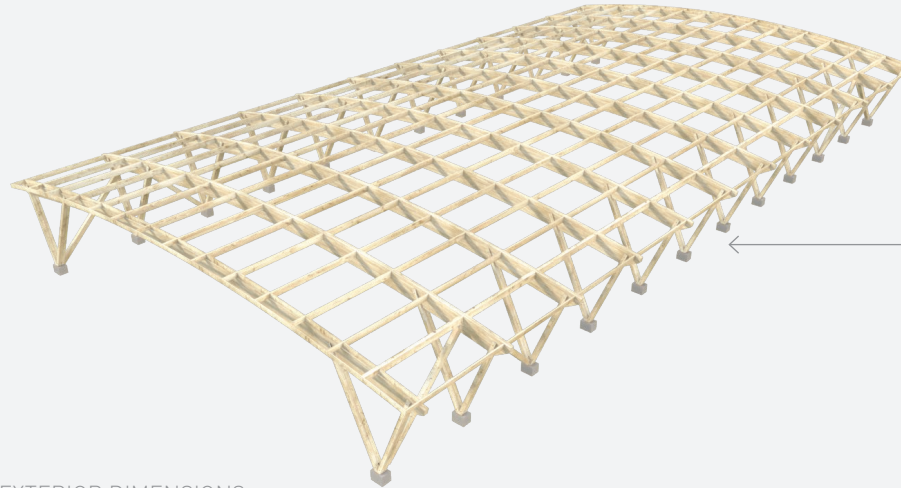

A REFINED DESIGN THAT USES DURABLE MATERIALS

**NORDIC LAM**  
CROSS-LAMINATED TIMBER  
STRUCTURE IN BLACK SPRUCE  
POSTS, BEAMS AND VERTICAL  
BRACES

PROTECTED BY A SEALANT



EXTERIOR DIMENSIONS  
121' x 206'-7"

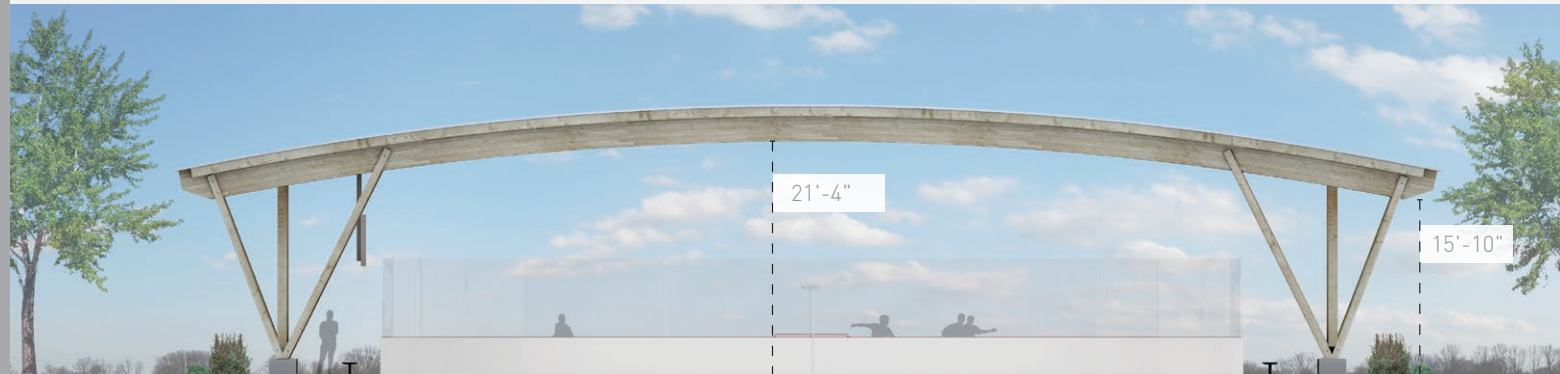

## CONTACT

---

VINCENT RENAUD

info@preau.ca  
514 507 3600

PREAU.CA

## PARTENAIRES

---

**BC2**

LE GROUPE  
**DECAREL**

## COLLABORATOR

---

**NORDIC**  
STRUCTURES